

Today's Host

Deborah Wingler,
PhD, MDS-HHE, EDAC

Vice President & Healthcare Research Lead
HKS, Inc.



View Options

Gallery View



Active Speaker

Audio

The image shows a Zoom meeting interface with a settings menu open. An orange arrow points from the microphone icon in the bottom toolbar to the 'Audio Settings...' option in the menu. Another orange arrow points from the top right of the Zoom window to the 'Speakers / Headphones (Realtek Audio)' dropdown menu in the Windows Settings window.

Zoom Meeting Settings Menu:

- Select a Microphone
 - ✓ Microphone Array (Realtek Audio)
 - Same as System
- Select a Speaker
 - Speakers (MP4 Recorder Virtual Audio Device)
 - LG Ultra HD (Intel(R) Display Audio)
 - ✓ Speakers / Headphones (Realtek Audio)
 - Same as System
- Test Speaker & Microphone...
- Switch to Phone Audio...
- Leave Computer Audio
- Audio Settings...

Windows Settings - Audio:

- Speaker:** Test Speaker | Speakers / Headphones (Realtek Audio) [dropdown]
- Output Level: [slider]
- Volume: [slider]
- Microphone:** Test Mic | Microphone Array (Realtek Audio) [dropdown]
- Input Level: [slider]
- Volume: [slider]
- Automatically adjust volume
- Use separate audio device to play ringtone simultaneously
- Automatically join audio by computer when joining a meeting
- Mute my microphone when joining a meeting
- Press and hold SPACE key to temporarily unmute yourself
- Sync buttons on headset
- Advanced

Side-by-side

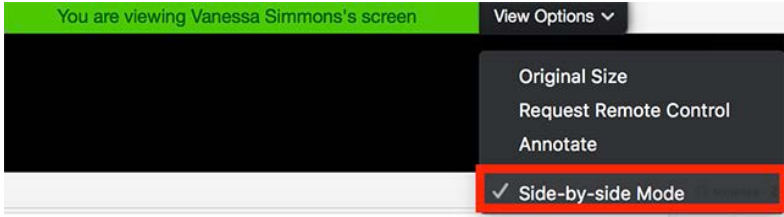

During
screen share

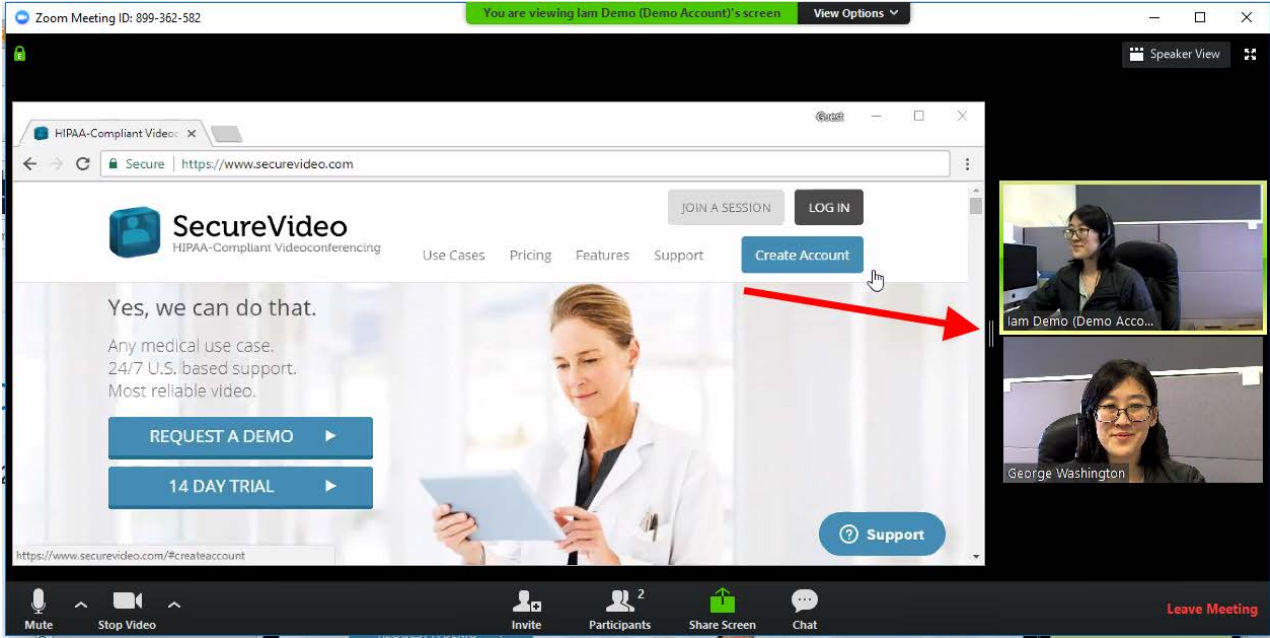

How-To Ask Questions

- To ask content questions, click on the Chat icon on your toolbar.



- Chat to “Everyone” (default).
- If you are having technical difficulty, send a private chat to “The Center for Health Design” only.

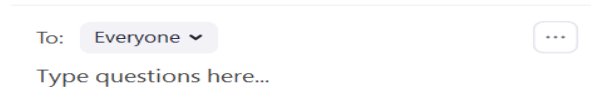
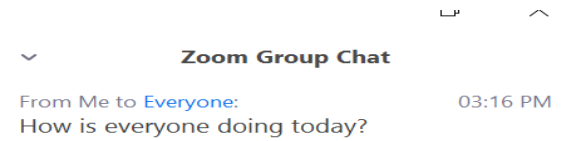
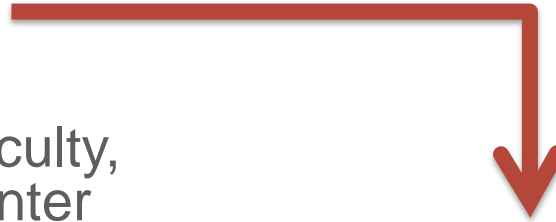

EDAC & AIA CEUs Available

Download additional information from the “Chat” icon on the bottom of your toolbar or go to <https://tinyurl.com/ebdjc430>

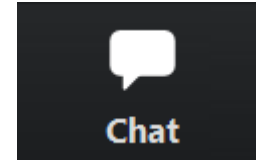

- **EDAC CEU** – complete the Verification Form and retain it for your records.
 - You will need to submit the form to Castle Worldwide at the time of your renewal.
- **AIA CEU** – complete the Verification Form and Quiz.
 - Once complete, email it to The Center for Health Design (email address included on the form).

EVENTS & WEBINARS



24hr Webinar Pass

\$65.00



CEU Management Fee

\$12.00

Thank you

Thank you to the *HERD Journal* for donating access to the articles.

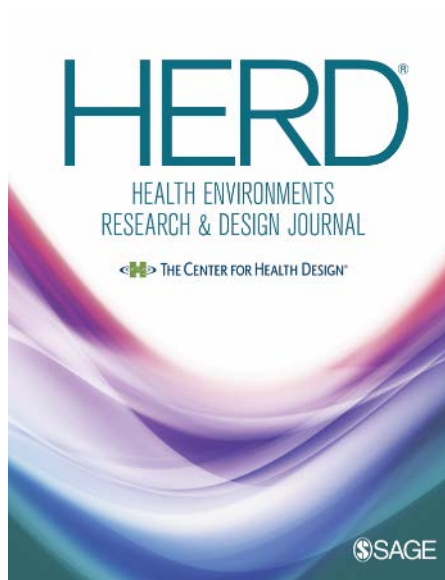

www.herdjournal.com

Thank you

Thank you to our EBD Journal Club Sponsor

patcraft[®]

The purpose of the
EBD Journal Club
is to broaden the healthcare
community's **knowledge,**
understanding and **application**
of built environment research.

Today's Authors

Jonas Shultz, MSc, EDAC

Human Factors Specialist
Health Quality Council of Alberta
-and-

Adjunct Lecturer, Department of Anesthesiology
University of Calgary

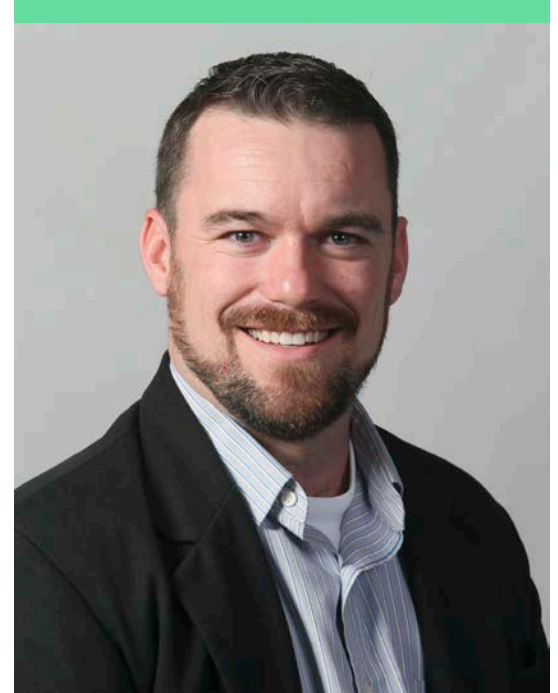

Today's Authors

Shelly Fleck, MBA

Director Strategic Initiatives, VA;
Operations Director, Surgical Services,
VA & VGH Simulation Center



A Quick Overview of the Study

© 2020 The Center for Health Design



DESIGNCAN

Unleashing Design's Healing Power

Objectives and Aims

- Design a “universal OR” (any case, any room)
- 7 Flows of Medicine
- Patient and Staff safety paramount
- Design needs to work for all team members
- Opportunity to create new design, new habits, new flows vs “just make it work”

Background

- Vancouver General Hospital
- Mock Scenarios:
 - Iterative
 - 650 sqft, square
 - Real OR equipment where possible
 - +++ stakeholder engagement
 - 18 in total (multiple services, all team members represented)
 - Changes made after every 3rd mock

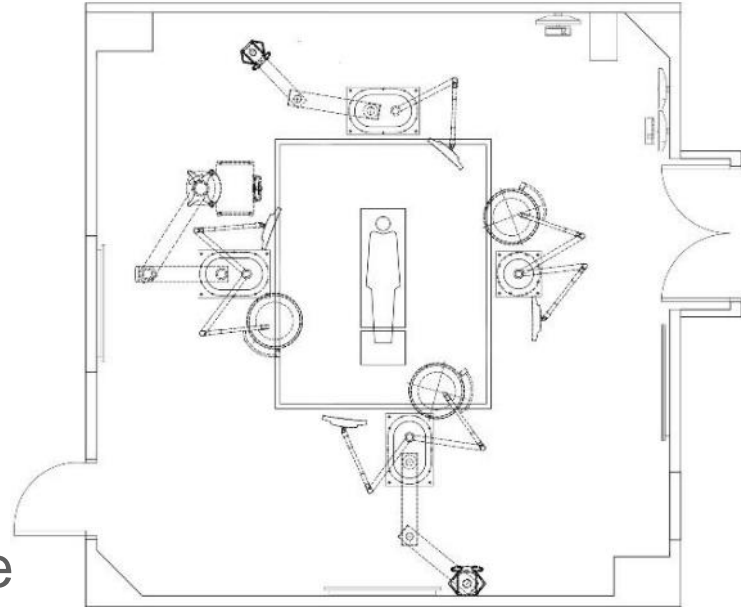

Methods

- Simulation-based mock-up evaluation framework
 - Document available from:
<https://www.hqca.ca/humanfactors>

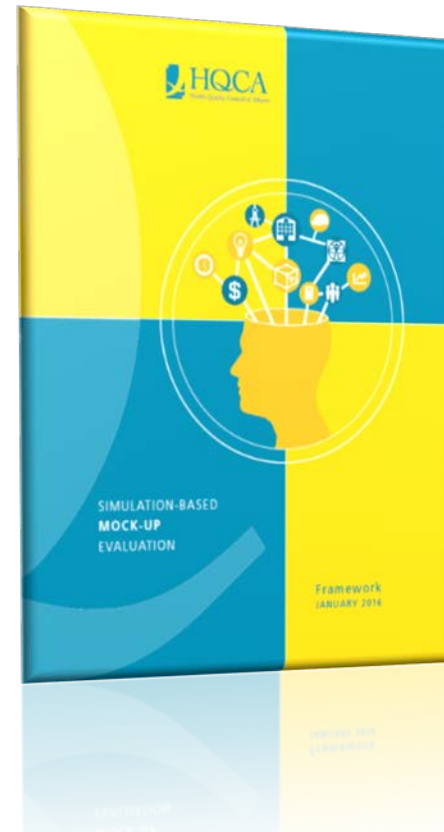

Methods



Methods - Scenarios

Total Abdominal
Hysterectomy



Laparoscopic
Cholecystectomy



Thyroidectomy



Scoliosis
Spinal Fusion



Iteration 1 (Oct 2017)

Iteration 2 (Jan 2018)

Results/Findings

Iteration 1 (Lap Chole)

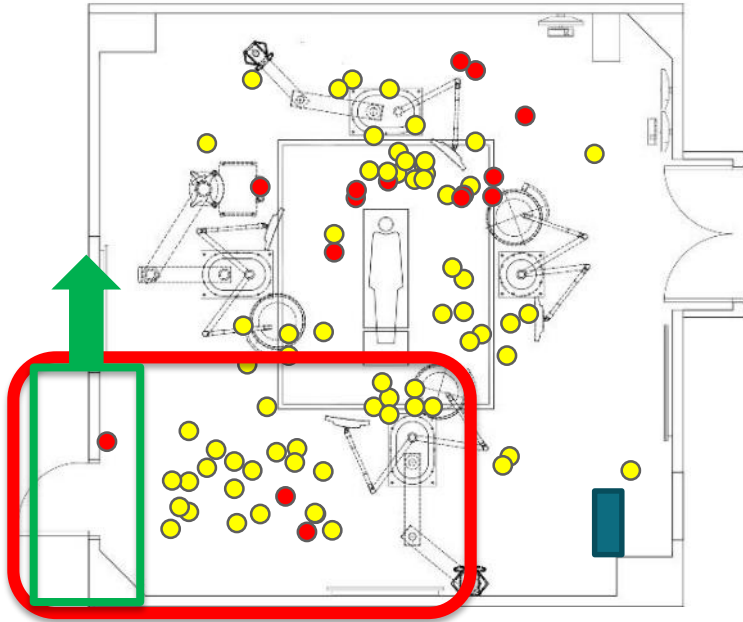

Iteration 2 (Lap Chole)

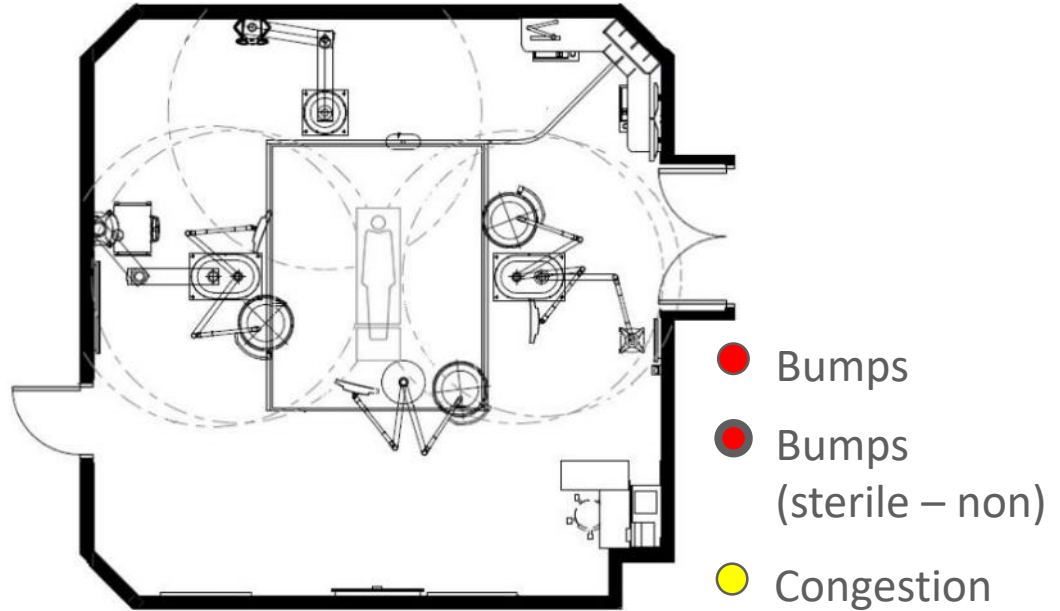

Results/Findings

Iteration 1 (Lap Chole)

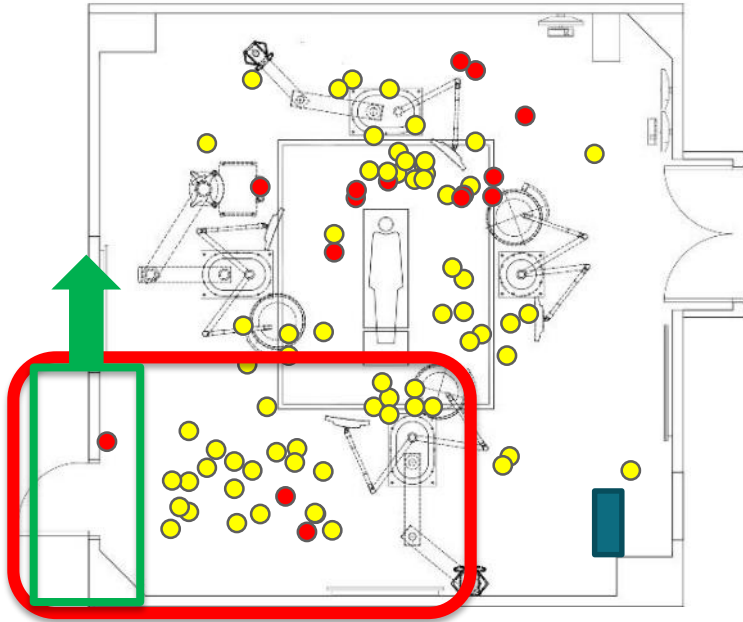

Iteration 2 (Lap Chole)

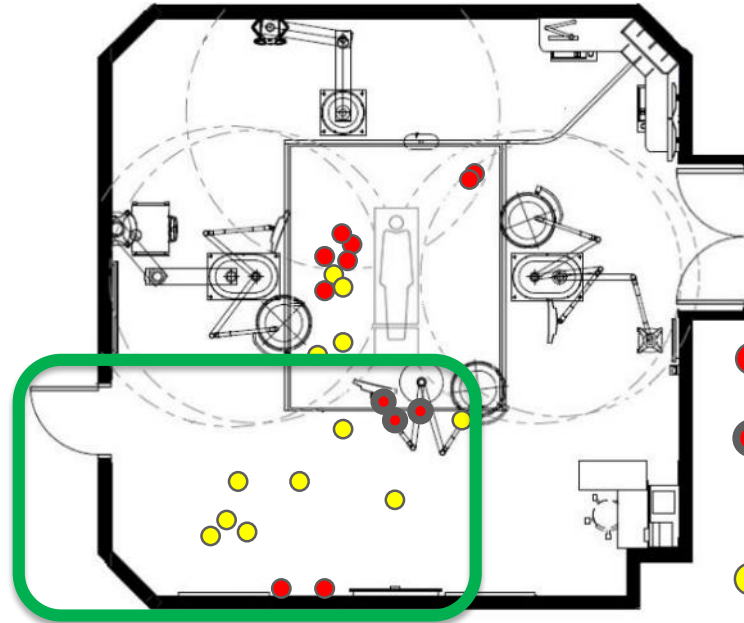

- Bumps
- Bumps (sterile – non)
- Congestion

Results/Findings

Iteration 1

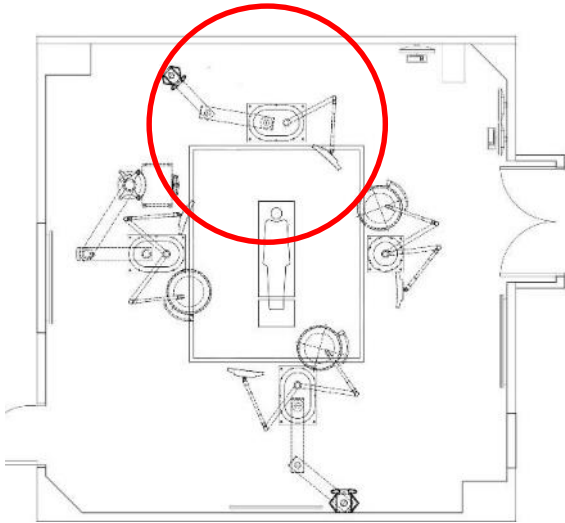

Iteration 2

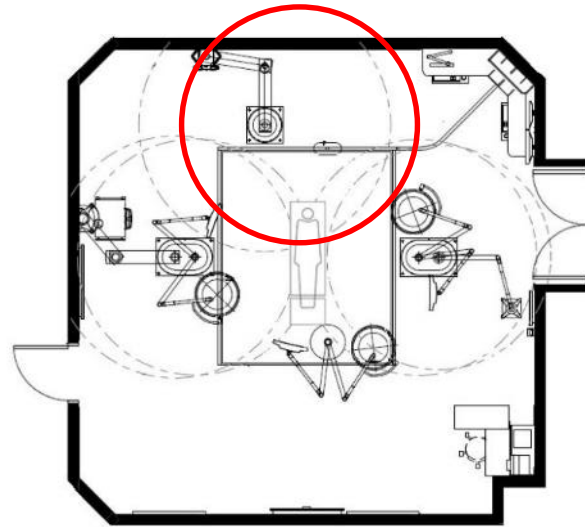

Aux boom



Anes machine



Results/Findings

Iteration 1

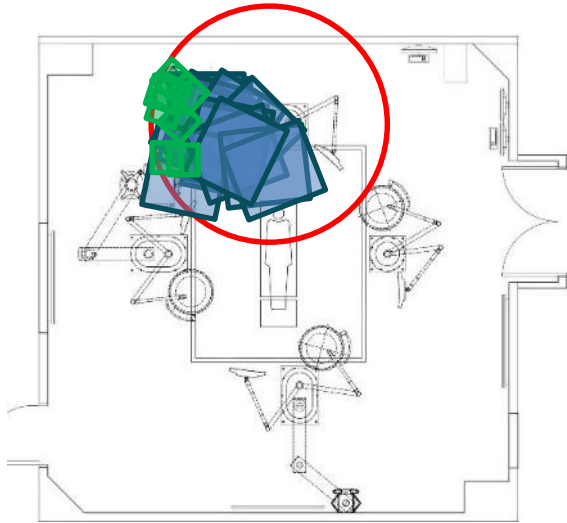

Iteration 2

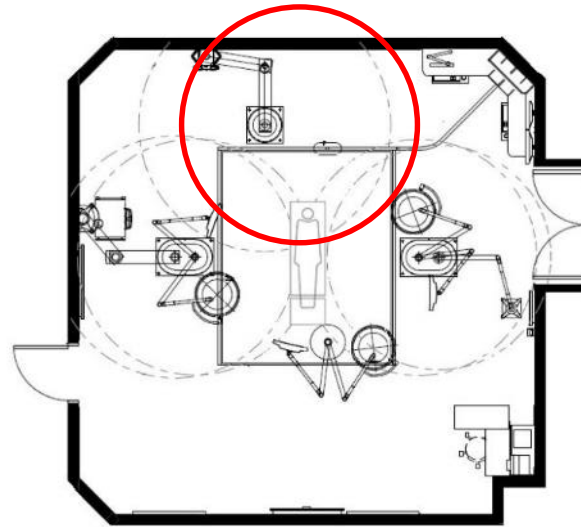

Aux boom



Anes machine



Results/Findings

Iteration 1

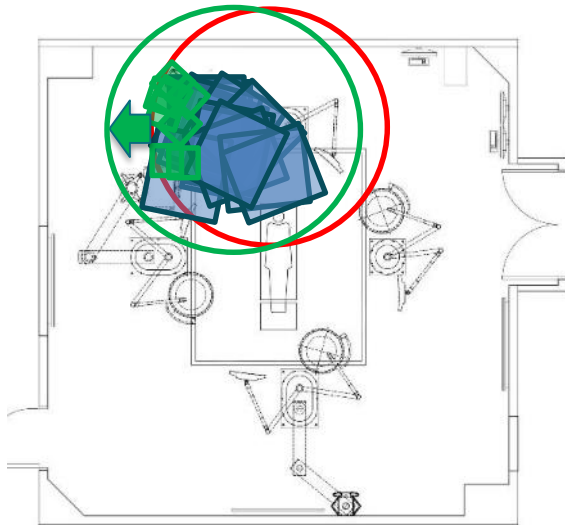

Iteration 2

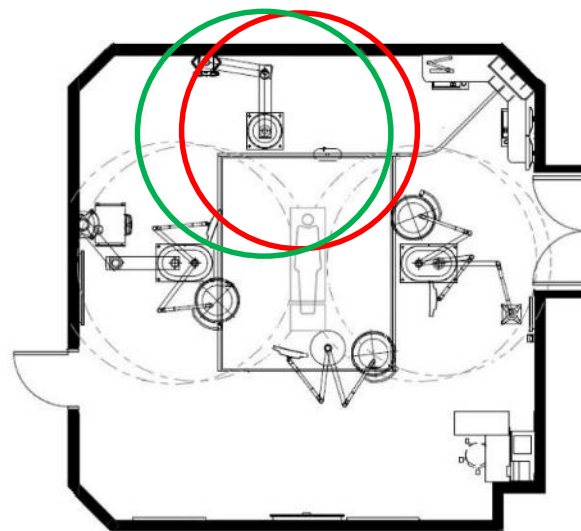

Aux boom



Anes machine



Results/Findings

Iteration 1

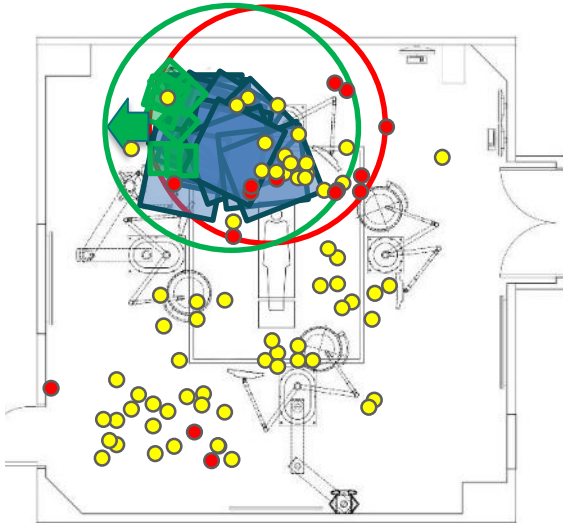

Iteration 2

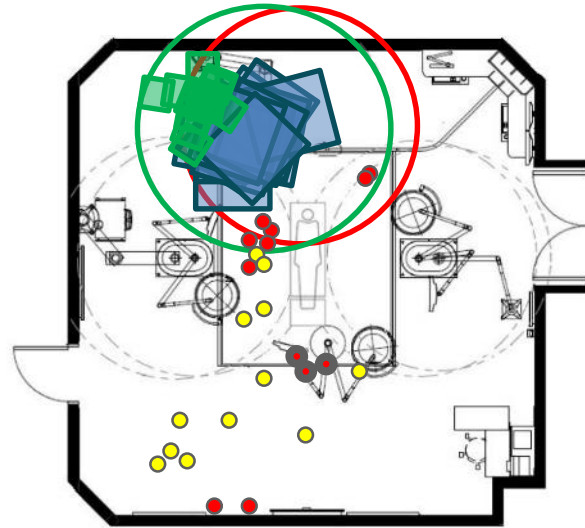

Aux boom



Anes machine



Results/Findings

The design changes resulted in:

- Better room utilization
- Fewer constraints with equipment mobility
- Decreased congestions
- Positive debriefing feedback





HECOTOL

FORM HOLDER

FORM HOLDER

HAND RUB

GLOVE BOX
GLOVE BOX
GLOVE BOX
GLOVE BOX
GLOVE BOX

HECOTOL
HECOTOL
HECOTOL

Virtual Room
Divisor



GLOVE
BOX
GLOVE
BOX
GLOVE
BOX
GLOVE
BOX

HAND
RUB



Results/Findings

- Extend boom arm for anesthesia
- Relocated power / data outlets
- Redesigned the nursing shelf
- FMO – temperature monitor moved
- STAFF OWNED THE ROOM!

Discussion

© 2020 The Center for Health Design



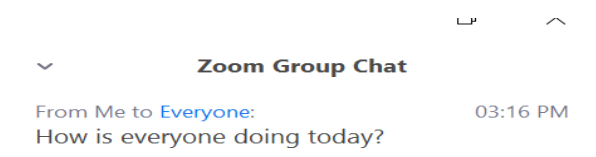

Q & A

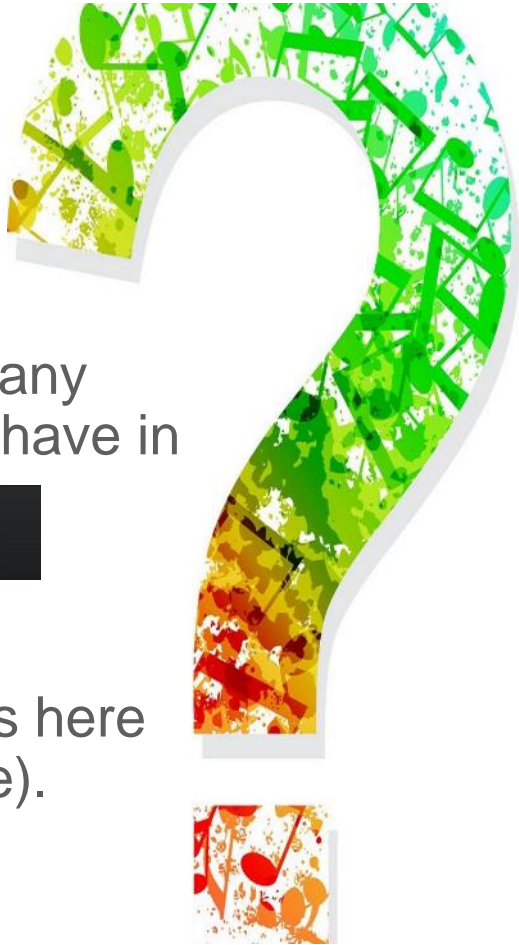

Feel free to type in any questions you may have in the Chat box.

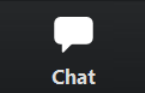

Type your questions here (Default = Everyone).



Thank you

Thank you to the *HERD Journal* for donating access to the articles.

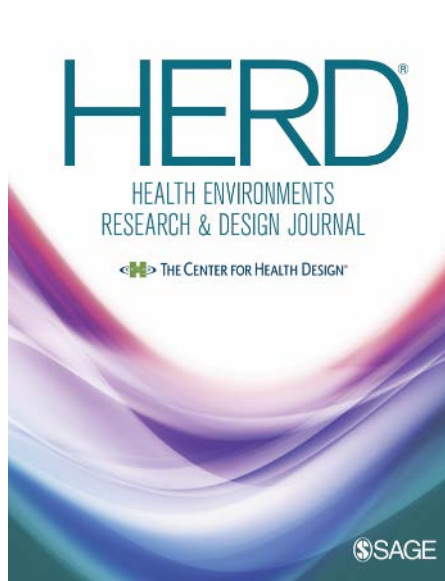

www.herdjournal.com

Thank you

Thank you to our EBD Journal Club Sponsor

patcraft®

BEHAVIORAL HEALTH
Virtual
Workshop
MAY
14/21/28



PEDIATRICS
Philadelphia
SEPT
16



BEHAVIORAL HEALTH
Baltimore
SEPT
23



AGING
Baltimore
SEPT
24



EDAC & AIA CEUs Available

Download additional information from the “Chat” icon on the bottom of your toolbar or go to: <https://tinyurl.com/ebdjc430>

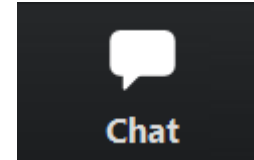

- **EDAC CEU** – complete the Verification Form and retain it for your records.
 - You will need to submit the form to Castle Worldwide at the time of your renewal.
- **AIA CEU** – complete the Verification Form and Quiz.
 - Once complete, email it to The Center for Health Design (email address included on the form).

EVENTS & WEBINARS



24hr Webinar Pass

\$65.00



CEU Management Fee

\$12.00